

PROPOSED
GROUND FLOOR

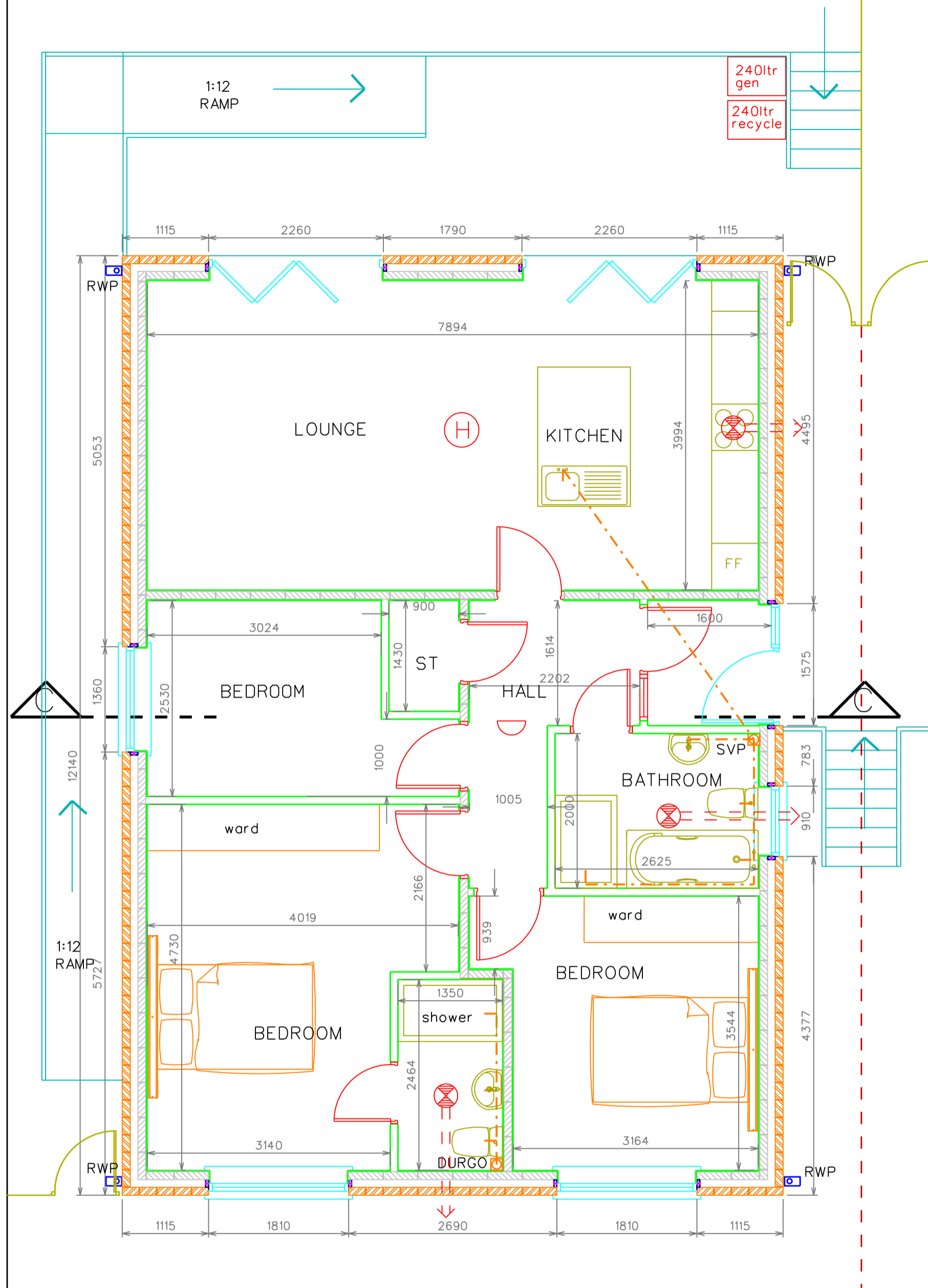

PROPOSED
HOUSE TYPE C

PROPOSED
MASONRY SIZES

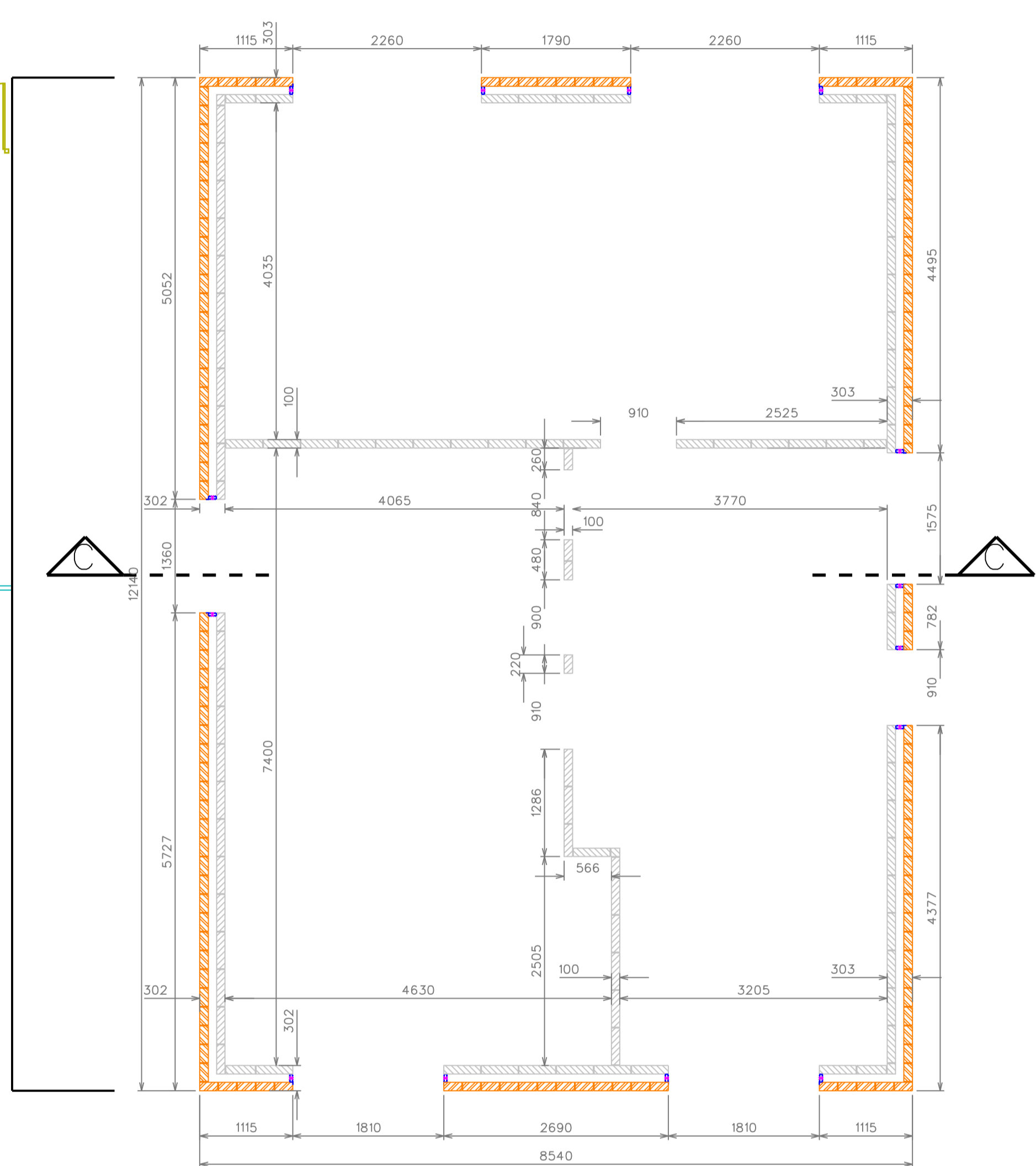

PROPOSED ROOF PLAN

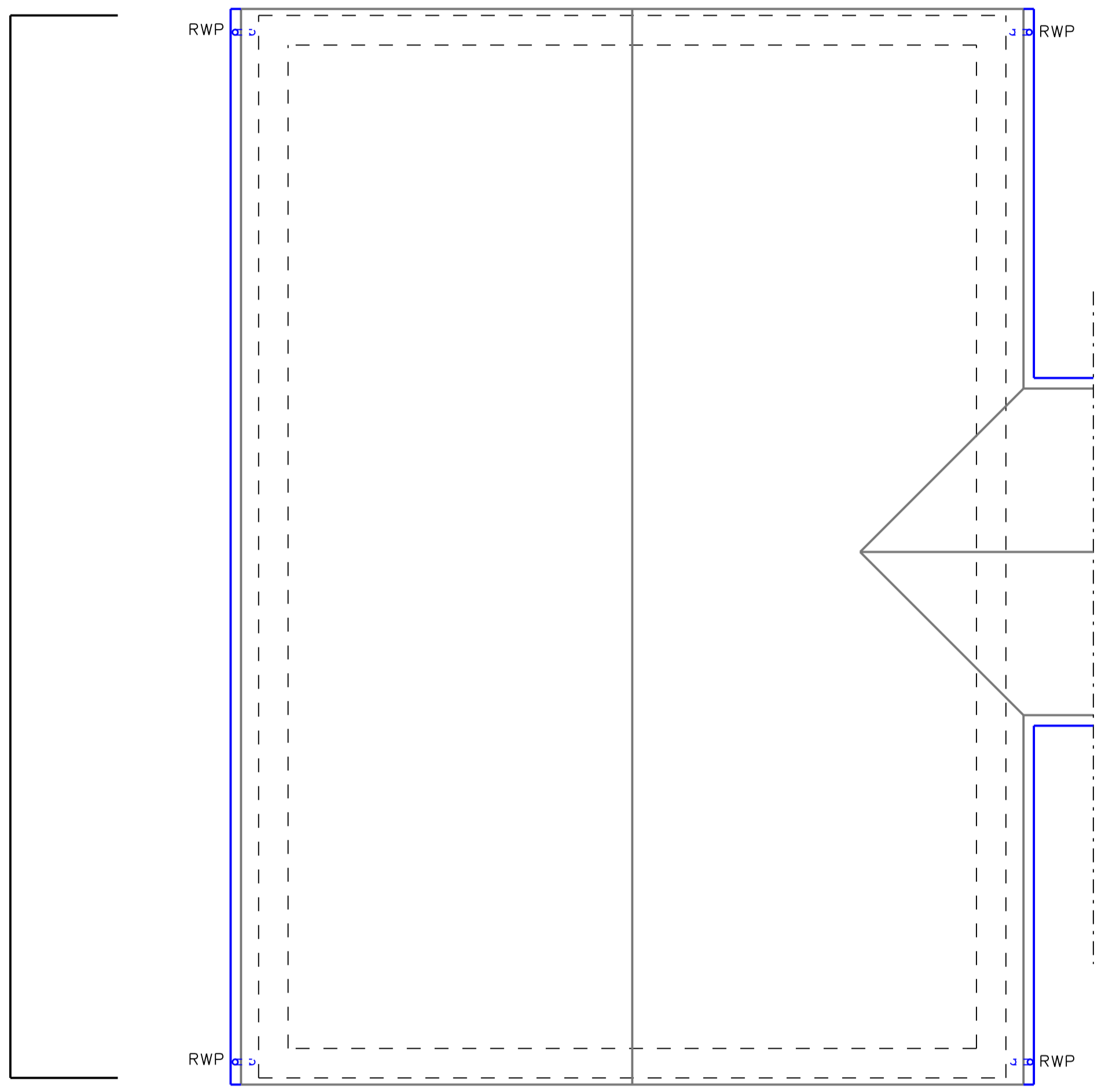

PLEASE NOTE THAT THE EXTERNAL STAIR/RAMP ACCESS & PATIO IS SHOWN FOR PLOT 1, SO THIS MAY ALTER FOR REMAINDER PLOTS

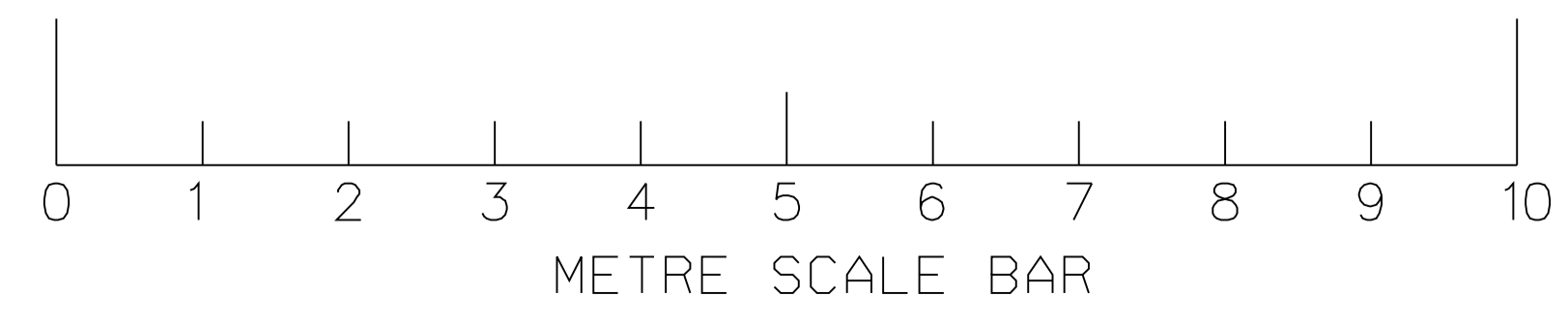

| FIRE SAFETY | NOTE |
|---|--|
| extractor fan with timer option | <p>NOTE: SWITCHES AND SOCKET OUTLETS FOR LIGHTING AND OTHER EQUIPMENT SHOULD BE LOCATED SO THAT THEY ARE EASILY REACHABLE AS BUILDING REGULATIONS PART M, SECTION 8.</p> <p>SWITCHES AND SOCKET OUTLETS FOR LIGHTING AND OTHER EQUIPMENT SHOULD THUS BE LOCATED BETWEEN 450MM - 1200MM ABOVE F.F.L.</p> <p>HEATING, VENTILATION AND SECURITY SYSTEMS/CONTROLS TO BE DESIGNED AND SUPPLIED BY SPECIALIST.</p> |
| automatic detector | |
| heat detector | |
| INSTALLATION LAYOUT INDICATIVE ONLY SUBJECT TO CURRENT CODES & DESIGN STANDARDS | |

| INTERNAL WALL LEGEND | |
|--|---|
| | <p>Masonry Wall 100mm wide block (1850-2300kg/m3) 10mm mortar beds with 13mm lightweight plaster (min. mass per unit area 10kg/m2). 1hr. F.R.</p> |
| | <p>Non-Loadbearing Partition 70mm timber studs at 600mm centres with 50mm Rockwool flexiinsulation in-between. Finished with 1no. layers of 15mm Gyproc SoundBloc each side. Overall thickness 100mm. 30min. F.R. & 40 Rw dB sound insulation.</p> |
| All walls to received a nominal 2mm skim plaster finish. | |

| | |
|----------|-------|
| REVISION | NORTH |
|----------|-------|

STAGE* BUILDING REGULATIONS

PROJECT
RESIDENTIAL DEVELOPMENT
EX SKINBURNNESS HOTEL,
SKINBURNNESS, CUMBRIA,
CA7 4QY

DRAWING
PROPOSED HOUSE TYPE C
FLOOR & ROOF PLANS

| | | |
|---------------------|------------------------------|-----------------|
| PROJECT NO. 3741 | DRAWING NO. D-20 | REVISION |
| DATE JAN '26 | SCALE 1:500A1 1:1000A3 | DRAWN BY DJB |

MARIO MINICHELLA ARCHITECTS

UNIT 4, WITNEY WAY,
HI-TECH VILLAGE,
SOLDON BUSINESS PARK,
TINE AND WEAR
NE25 9PE
T: 0191 3882227
W: WWW.M-M-A.NET
E: INFO@M-M-A.NET

THIS DRAWING IS
COPYRIGHT OF
MMA

NOT TO BE SCALED
ALL DIMENSIONS TO
BE CHECKED ON SITE