

- NOTES:
- DO NOT SCALE FROM THIS DRAWING
 - THE CONTRACTOR SHALL BE RESPONSIBLE FOR CHECKING AND VERIFICATION OF ALL DIMENSIONS ON SITE PRIOR TO COMMENCEMENT
 - THE CONTRACTOR SHALL CONFIRM AND BRING TO THE ATTENTION OF THE ENGINEER ANY DISCREPANCIES CONTAINED IN THIS DRAWING PRIOR TO COMMENCEMENT.

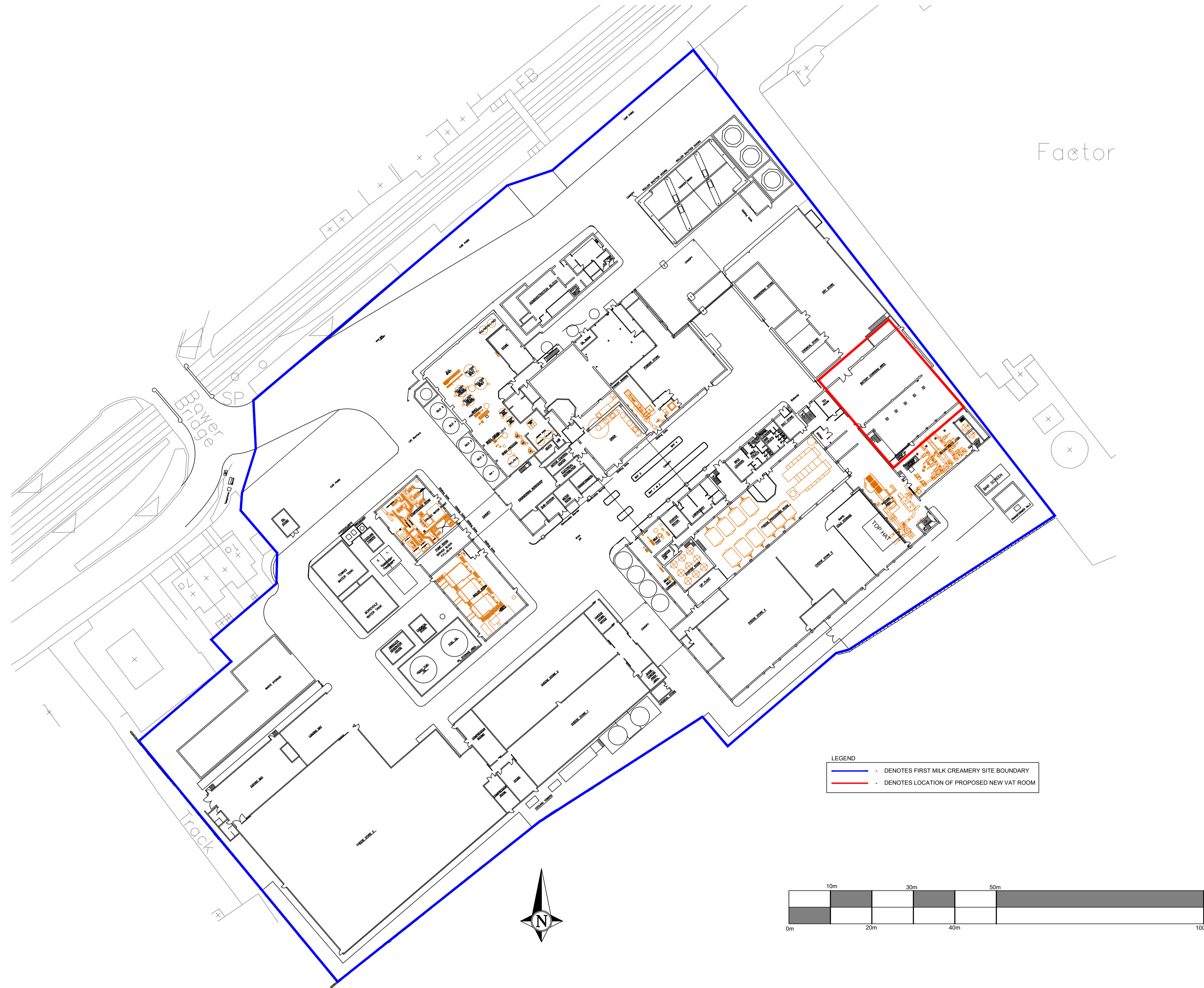

Rev	Description	Drwn	Chkd	Date
A	New VAT room location outline added.	DQ	SF	02/12/2025

Indev Consult
 Phone: 01698 744 610
 Email: info@indevconsult.com
 Website: www.indevconsult.com
 Address: Quarf House, 3 Finch Way, Strathclyde Business Park, Bellshill, ML4 3PZ

firstmilk
 The Regenerative Co-op

Project Title: NEW VAT ROOM
 FIRST MILK
 ASPATRIA

Drawing Title: EXISTING SITE PLAN

Drawn By: DQ Checked By: SF Issue Status:

Date Drawn: 10/06/2024 Scales: 1:500

Drawing Number: 24-057-201 Revision: A