

Please Note;

Trees 4 & 6 removed following the initial survey.  
They are no longer shown on the site plans.

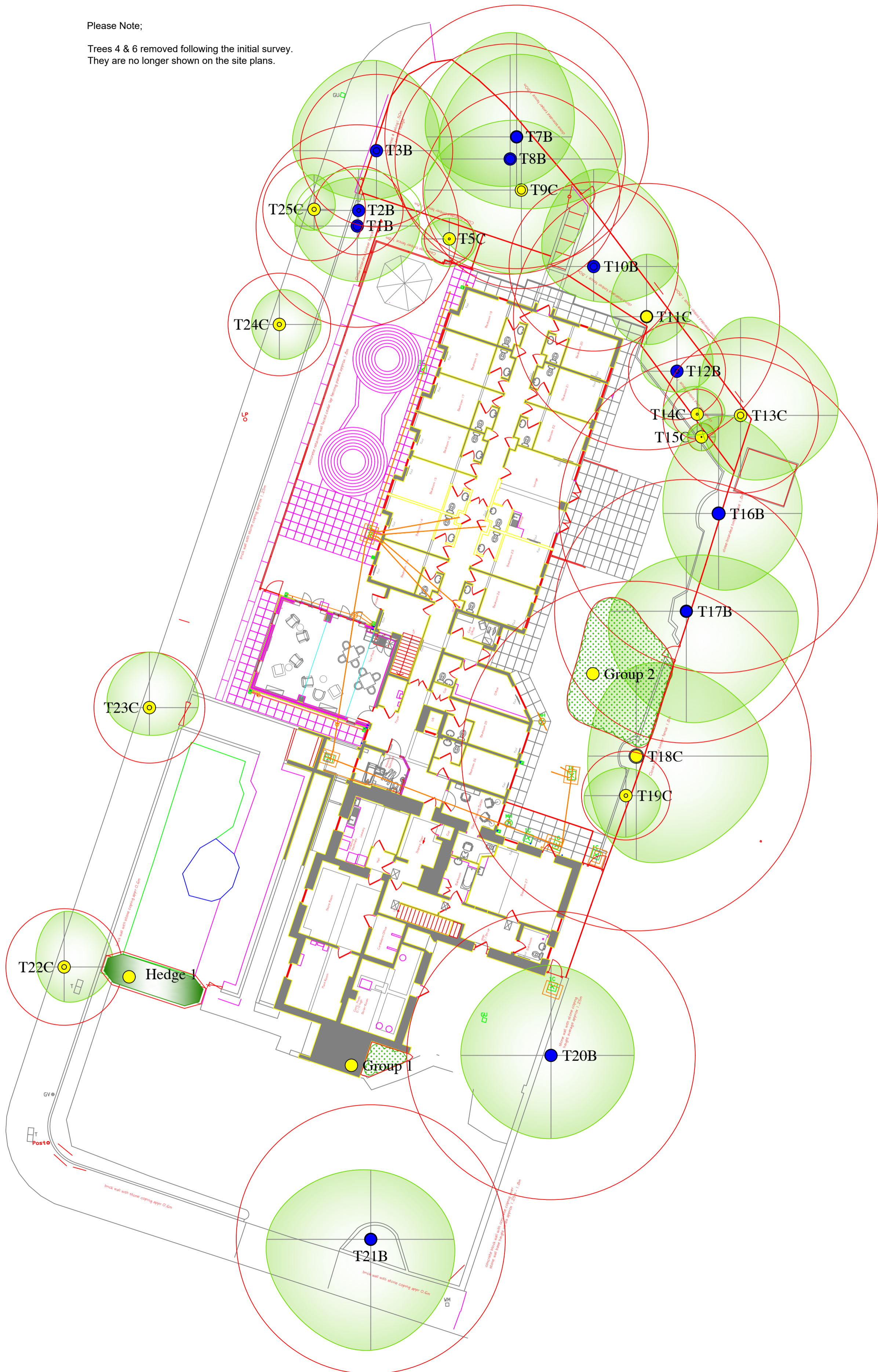

© This drawing should only be used for the purpose for which it is intended, all rights are reserved and it should not be reproduced without written permission. All dimensions should be checked on site and any discrepancies, ambiguities and/or omissions between this drawing and information issued in the accompanying report should be forwarded to this office for clarification before proceeding.

The original of this drawing was produced in colour - a monochrome copy should not be relied upon.

**Key:**

- Tree Number
- Tree Crown True Shape (Shaded Light Green)
- Tree Quality Assessment Centre Colours As Below
- Green Centre = High Quality (Denoted By Letter A)
- Blue Centre = Moderate Quality (Denoted By Letter B)
- Yellow Centre = Low Quality (Denoted By Letter C)
- Red Centre = Unsuitable To Retain (Denoted By Letter U)
- BS Root Protection Area As Shown By The Red Circle Around The Tree
- Tree / Woodland Groups Root Protection Area Shown By Red Outline Surrounding Group
- Hedgerows Root Protection Area Shown By Red Outline Surrounding Hedge



**Institute of Chartered Foresters**  
Registered Consultant

Arboricultural Impact Assessment  
& Method Statement  
Existing Trees Shown On Existing Layout  
The Good Companions,  
Silloth - Revision A  
For  
David J Kershaw

**AllAboutTrees Ltd**  
Arboricultural & Ecological Consulting  
Chartered Arboriculturalists & Environmentalists

The Old School, Quarry Lane,  
Butterknowle, Co. Durham, DL13 5LN  
Tel 0191 3739494 01388 710481  
email info@allabouttrees.co.uk www.allabouttrees.co.uk

Drawn at Durham Office By TA Checked by AW

Scale 1:200 at A2 Date 09.05.25

|   |  |                      |
|---|--|----------------------|
| -Registered Chartered<br>-Arboricultural Consultants<br>-Planning & Development<br>-Urban Forestry<br>-Ecological Consultants | Drawing Ref.<br><b>AIA &amp; AMS<br/>Exi</b> | Revision<br><b>A</b> |
|---|--|----------------------|